

# Worker Bee DNA sample Guide

**1** Place the sample tube tag in the bottom part of the pliers

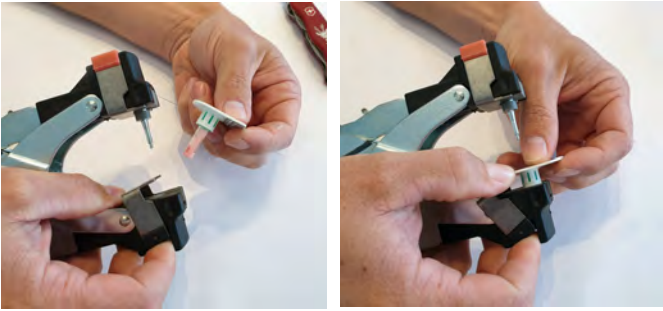

**2** Place the cutting tag in the top part of the pliers

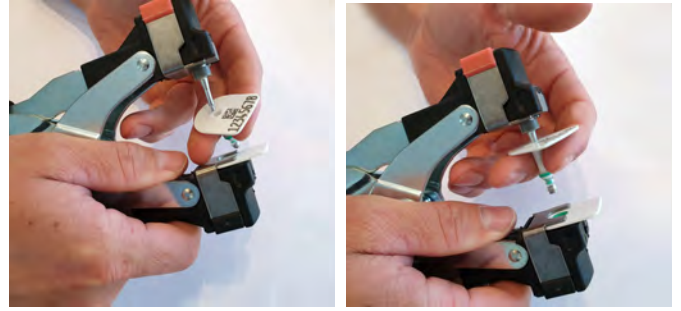

**3** Place the flight muscle on the opening of the sample tag (bottom)



**4** The pliers are now ready to be closed together



**5** Once the pliers are closed, the sample is released into the bottom of the tube



**6** Open the pliers and take out the top tag



**7** Push up the sample tube with your nail



**8** Take out the sample tube

